

▶ blackline ▶

an OBL brand

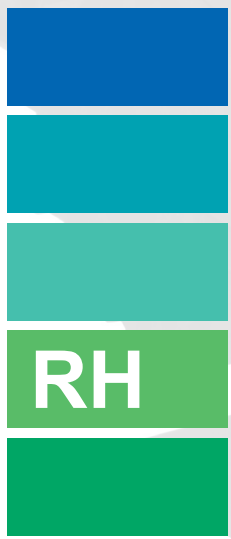

WATER DIVISION

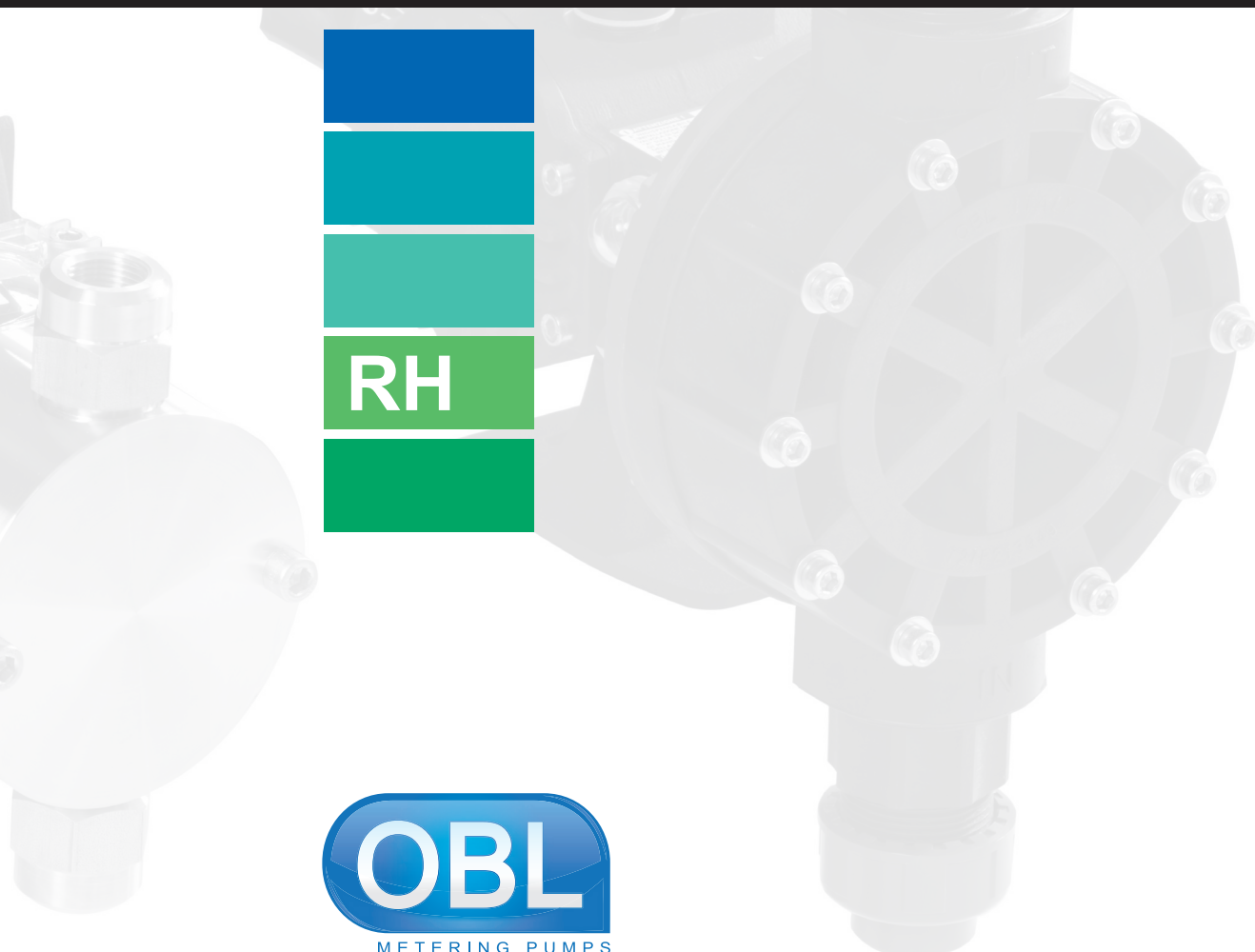

Painted cast iron casing:
Improved corrosion resistance against aggressive fumes. Extends pump life and lowers life-cycle cost.

Motor UNEL-MEC:
Motor UNEL-MEC standard 3 phase, 50/60Hz. Single phase and ATEX options available. Permits standardization and quick std motor availability on site.

Transparent covers and protection comply to EC Directive

Spring return mechanism with oversized bearing.
Extends pump life and lowers life-cycle cost.

Painted cast iron yoke:
Increased resistance in case of liquid spillage to reduce maintenance cost. Extends pump life and lowers life-cycle cost.

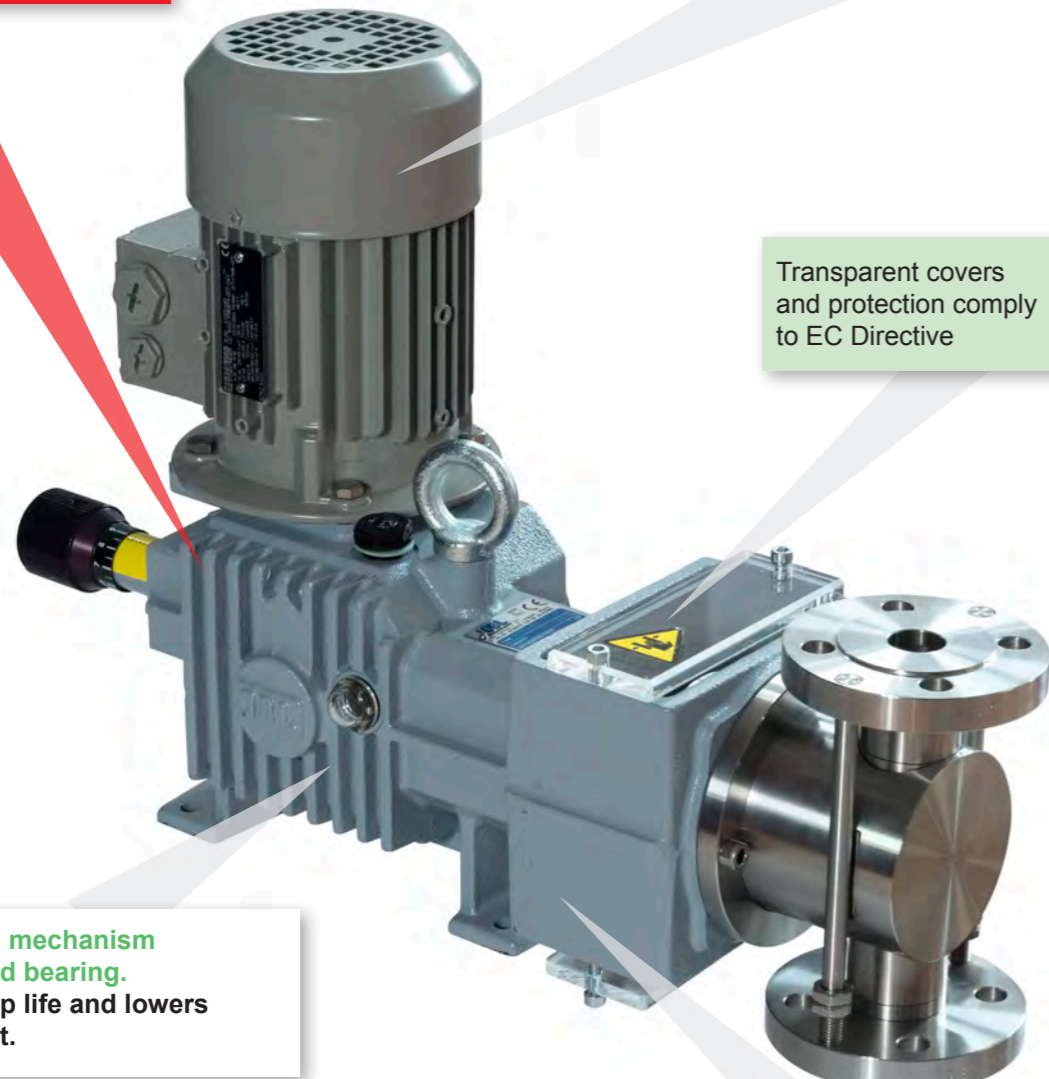

UP TO 620 l/h

ATEX

ALL models comply to ATEX (2014/34/CE) Group II, Category 2 (zone 1/21) and Group II, Category 3 (zone 2/22).

Technical data

TYPE	50 Hz		60 Hz		MAX PRESS. bar			CONNECTIONS		
	STROKES / 1	MAX FLOW RATE l/h	STROKES / 1	MAX FLOW RATE l/h	A	A-TL	P	THR. / FLANGED		
								BSP f	UNI	ANSI
RH 20	63	28	50	22	10	40	/	3/8"	DN 15	1/2"
	86	38	75	33						
	104	47	98	44						
RH 25	63	44	50	34	10	40	10			
	86	60	75	52						
	104	75	98	70						
RH 30	63	64	50	50	10	32	10			
	86	86	75	75						
	104	110	98	103						
RH 40	63	110	50	85	10	17	10	1/2"	DN 20	3/4"
	86	150	75	130						
	104	200	98	185						
RH 50	63	176	50	135	10	8	8	/	DN 25	1"
	86	240	75	205						
	104	300	98	280						
RH 65	63	300	50	235	6	/	6	/	DN 25	1"
	86	410	75	355						
	104	500	98	470						
RH 80	63	420	50	330	4	/	/	/	DN 25	1"
	86	620	75	540						

● 0,55kW

Material of construction

COMPONENTS	A	A-TL	AC	ACV	P
PUMP HEAD	AISI-316L	AISI-316L	AISI-316L	AISI-316L	PVC
PLUNGER	AISI-316L	AISI-316L	CERAMIC	CERAMIC	CERAMIC
PLUNGER PACKING	PTFE	PTFE	PTFE	VULKOLLAN	PTFE
VALVE GUIDE	AISI-316L	AISI-316L	AISI-316L	AISI-316L	PVC
VALVE SEAT	AISI-316L	AISI-316L	AISI-316L	AISI-316L	PVC
VALVE (BALL)	AISI-316L	AISI-316L	AISI-316L	AISI-316L	PYREX
VALVE SEAL	FPM	FPM	FPM	FPM	FPM

Overall dimensions

SINGLE PUMP - Manual Adjustment

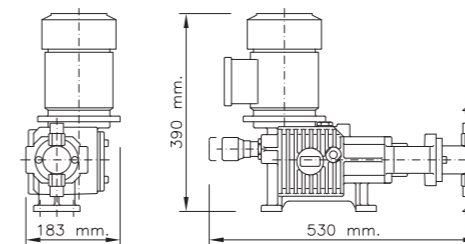

SINGLE PUMP - Electric Actuator Adjustment

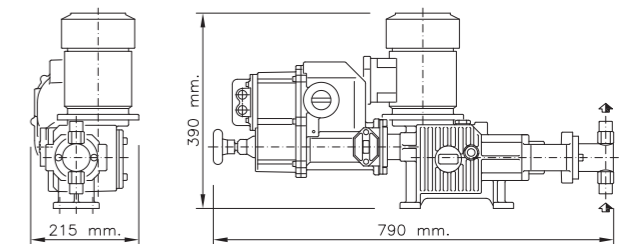

Sectional view

THREADED CONNECTIONS

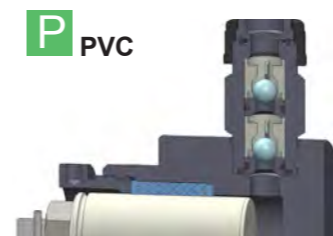

FLANGED CONNECTIONS

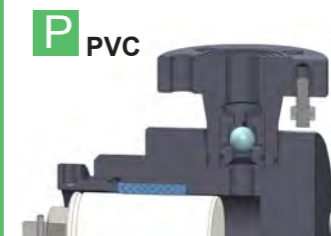

► Safe area

On all pumps M, ME, R, XRN it is possible to automate the control system by installing the OBL's electric actuator Z type (ZC or ZP).

ELECTRIC ACTUATOR CHARACTERISTICS

- IP 66 standard
- 115/230V – 1 – 50/60 Hz
- 4-20 mA feedback signal
- Manual emergency override
- Anticondensation heater (on demand)
- External automatic/manual selector (on demand)
- Flow-rate limiter (Q.max trimmer) allows to reduce the pump maximum flow-rate (corresponding to 20 mA command signal) up to 50% of the nameplate rated capacity.

The flowrate is adjusted according to following input signals:

- 4-20 mA, 0-20 mA, 20-4 mA and 0-10 V
- Pulses (0÷2 Hz - 0÷30 Hz)
- RS 485 communication protocol
- Profibus DP-V0



OBL DESIGN

oblblackline.com

OBL S.r.l.

Via Kennedy, 12
20090 Segrate (MI) - Italy
Tel. +39.02.269191
Fax +39.02.2133893
obl.info@idexcorp.com
oblpumps.it

